

Pull Out Basket Install Manual.

Accessories List

Frame (universal for right & Left)

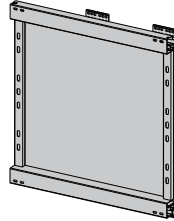

1

Door Bracket

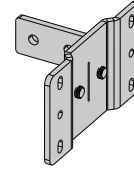

2pcs

2

Screw ST3.5*18

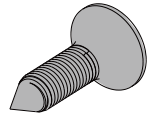

24pcs

3

Screw M6*10



8pcs

4

Basket (Option)

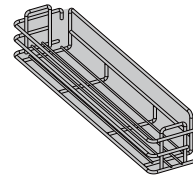

Wire Basket

5a

OR

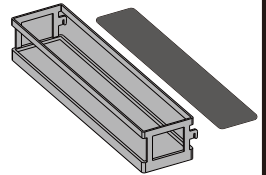

Wooden basket
(Matched with non-slip film)

3pcs

5b

Cabinet Size	Product Size(mm)
150mm	105*465*695
200mm	155*465*695
250mm	205*465*695
300mm	255*465*695

Step 1 Installation of Frame (Take the right size as an example)

1.1 Drill holes as below picture shown ϕ 2.5mm

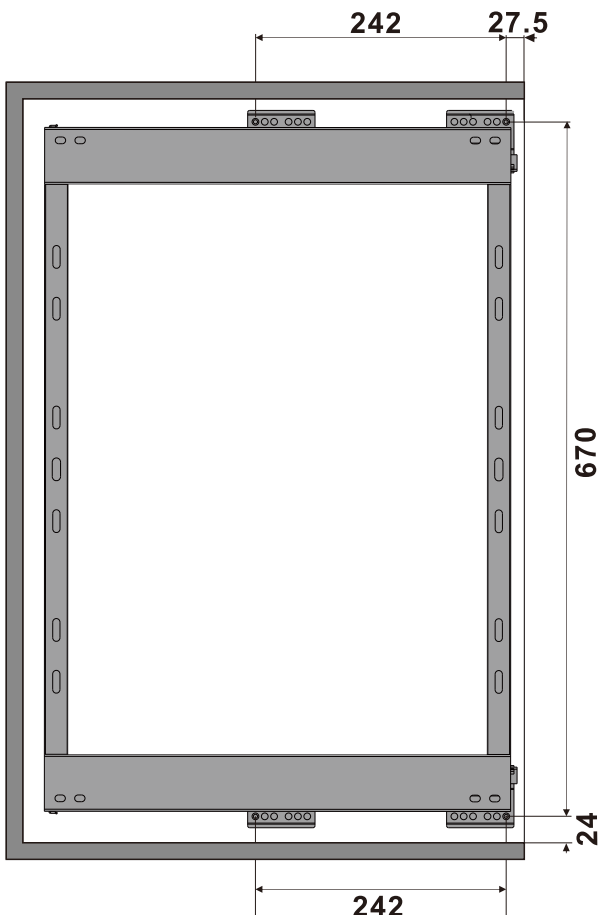

1.2 Fix the Screw ST3.5*18 after pulling out the frame

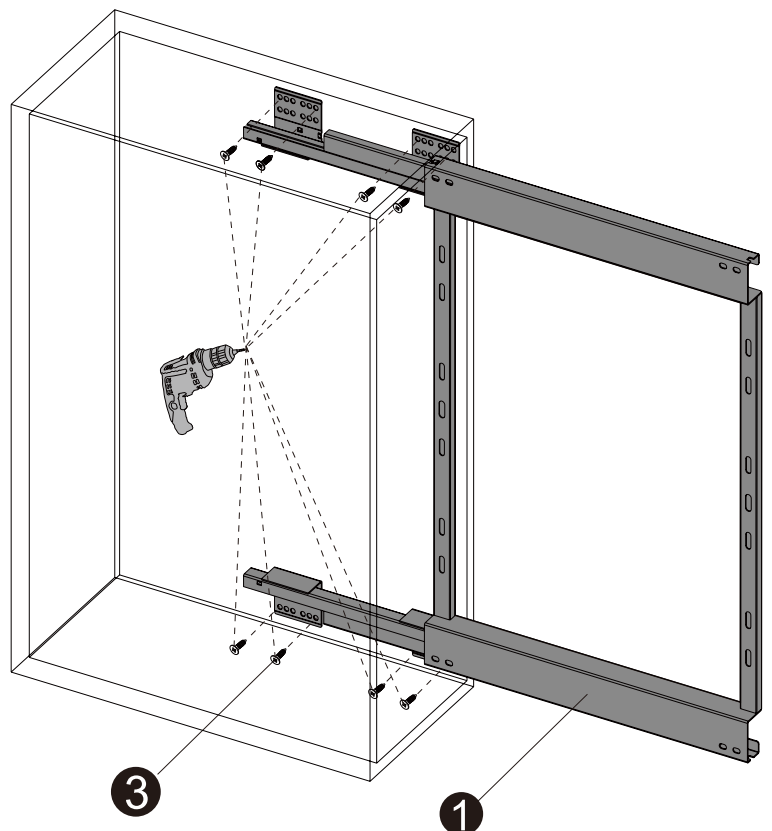

Step 2 Installation of Door Bracket

2.1 Drill holes as below picture shown ϕ 2.5mm, fix it to the door panel.

2.2 Adjust the holes in door bracket to the same position with the frame holes, tighten them closely

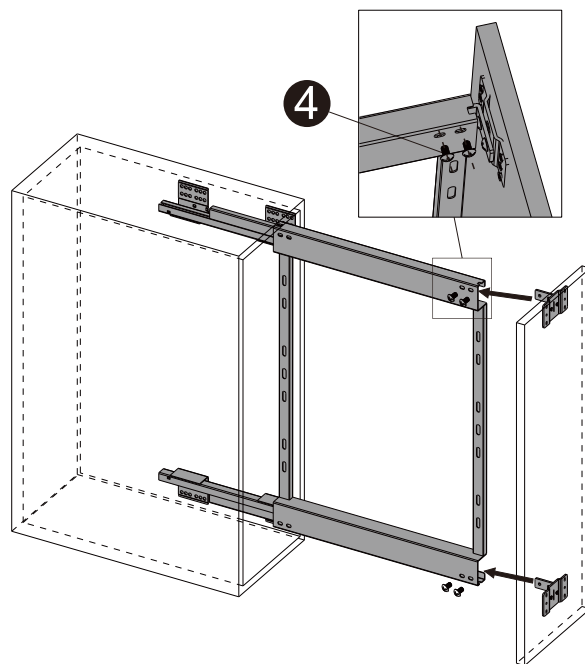
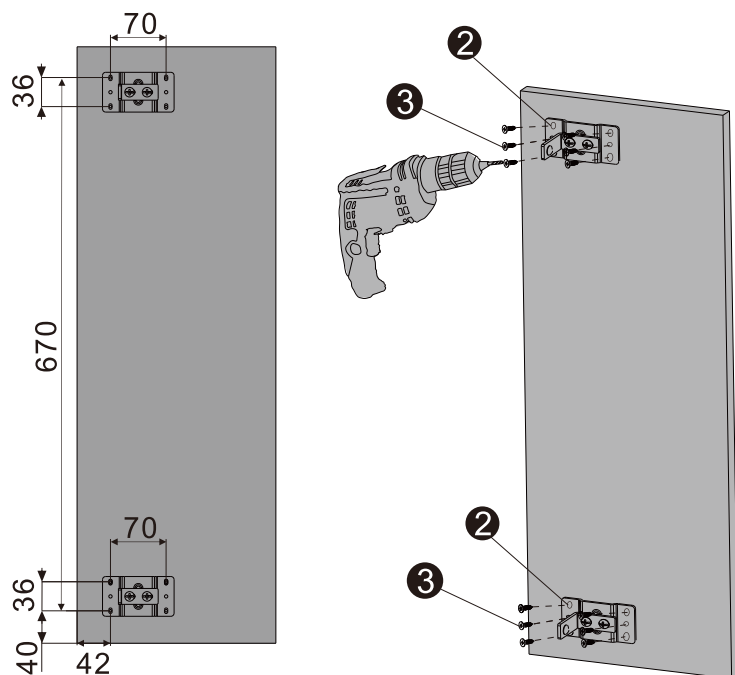

Step 3 Adjustment of Door Bracket

3.1 Adjust the door panel to the perfect position as below instruction, then tighten the screw

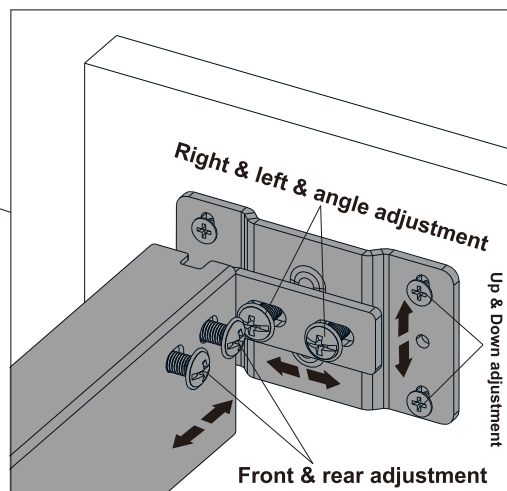
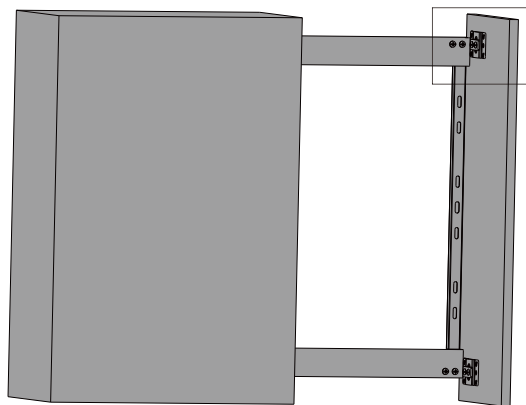

Step 4 Place the Baskets.

4.1 Hang up the baskets to the frame as below picture shown.

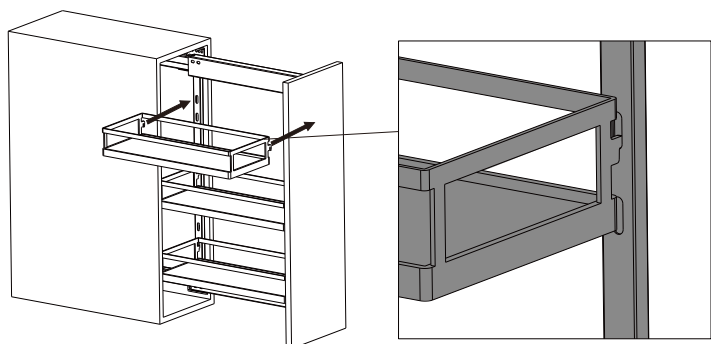

For Wooden basket

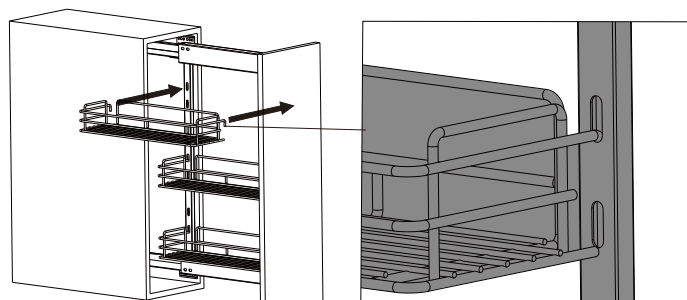

For Wire basket